

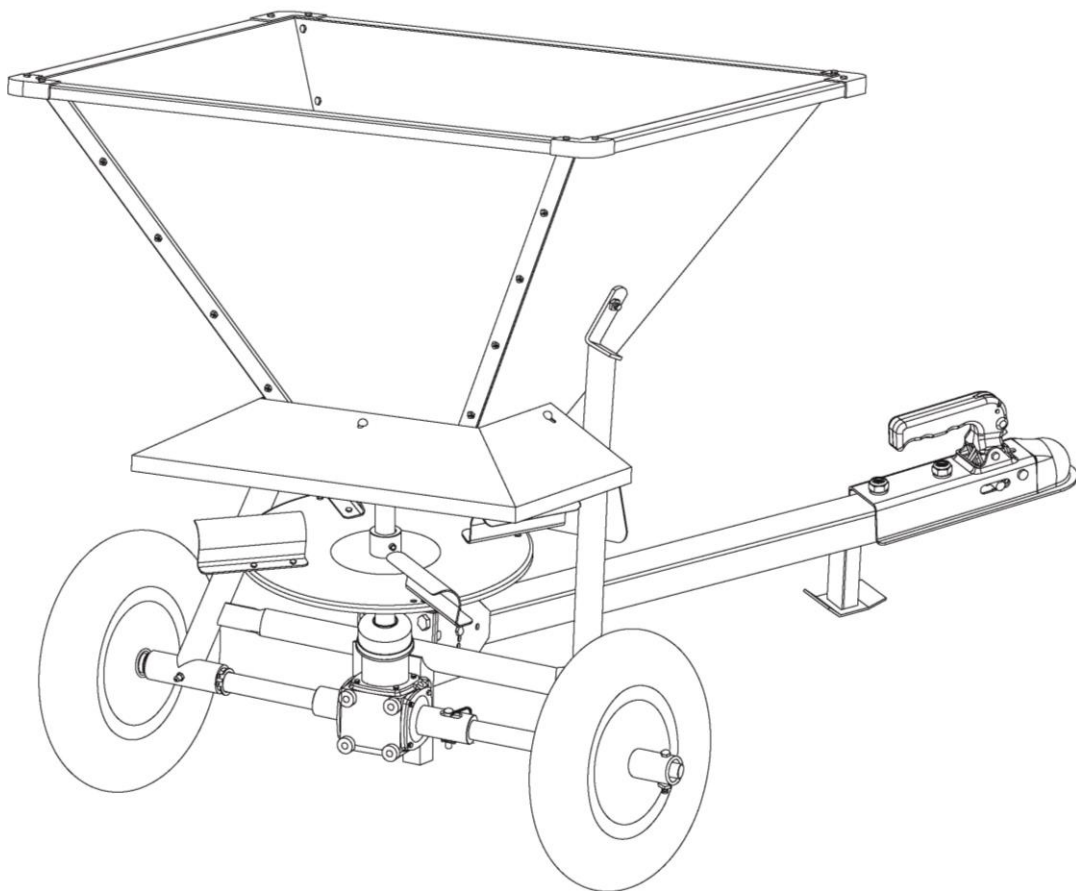

SHARK ATV SPREADER 160kg

800-00-43



Instruction Manual

Official Distributor:

ASP Group s.r.o.

Staroplzenecka 290, 326 00, Letkov, Czech Republic

+420 378 21 21 21 / info@aspgroup.cz

www.aspgroup.eu

STORAGE SAFETY

- Store the unit in an area away from human activity.
- Do not permit children to play on or around the stored machine.
- Wash thoroughly with a strong detergent to remove all chemical residue before storage.

OPERATING HINTS

- 1) Be sure you know the application rate for your machine and material. Calibrate in the field to be sure. Over application can waste material or damage crops. Under application may not give the desired results. This is particularly true when working with chemicals.
- 2) Wear appropriate protective clothing whenever working with chemicals. Even small amounts of a toxic chemical can affect you, animals, plants or the environment. Follow instructions exactly.
- 3) Stay 100 feet away from people, animals and building. Stop spreading if anyone comes closer. Particles from the spinner can injure the eye. Prevent injury.
- 4) Do not travel faster than the ground or terrain conditions will safely allow.
- 5) Do not allow riders. Riders can fall off and be injured.
- 6) Wear protective clothing appropriate for the chemical being used.
- 7) Keep hands, feet, hair and clothing away from moving parts.
- 8) Place all controls in neutral, stop tractor engine, set park brake, remove ignition key and wait for all moving parts to stop before servicing, adjusting, repairing or unplugging.
- 9) Place all tractor and machine controls in neutral before starting.
- 10) Never start or operate machine unless sitting on tractor seat.
- 11) Clear the area of bystanders, especially small children, before starting.
- 12) Use hazard flashers of tractor when transporting unless prohibited by law.
- 13) Review safety instructions with all operators annually.

OPERATING SAFETY

1. All things with moving parts are potentially hazardous. There is no substitute for a cautious, safe-minded operator who recognizes potential hazards and follows reasonable safety practices. The manufacturer has designed this Broadcast Spreader to be used with all its safety equipment properly attached to minimize the chance of accidents. Study this manual to make sure you have all safety equipment attached.
2. If a safety shield or guard is removed for any reason, it must be replaced before the machine is again operated.
3. When the use of hand tools is required to perform any part of assembly, installation, adjustment, maintaining, repairing, removal, or moving, be sure the tools used are designed and recommended by the tool manufacturer for the specific task.
4. Personal protection equipment including hard hat, safety glasses, safety shoes, and gloves are recommended during assembly, installation, operation, adjustment, maintaining, repairing, removal, or moving. Do not allow long hair, loose fitting clothing, or jewelry to be around moving parts.

5. Always use two people to handle heavy, unwieldy components during assembly, installation, removal or moving.
6. Never place any part of your body where it would be in danger if movement should occur during assembly, installation, operation, maintaining, repairing, removal or moving.
7. Never place yourself between the tractor and machine while implement is in operation.
8. Do not walk or work under a raised machine or attachment unless it is securely blocked or held in position. Do not depend on the tractor hydraulic system to hold the machine or attachment in place.
9. A heavy load can cause instability of the tractor. Use extreme care during travel. Slow down on turns and watch out for bumps. The tractor may need front counterweights to counterbalance the weight of the machine.
10. Never use alcoholic beverages or drugs which can hinder alertness or coordination while operating this machine while taking prescription medications.
11. Do not allow riders on the machine or tractor at any time. There is no safe place for any riders.
12. Before you operate the machine, check over all pins, bolts, and connections to be sure all are securely in place. Replace any damaged or worn parts immediately.
13. Do not allow anyone who is not familiar with the safety rules and operation instructions to use this machine.
14. Never allow children to operate or be around this machine.
15. Use stabilizer bars, adjustable sway chains, or sway blocks on the tractor lift arms to keep the machine from swinging side to side. Adjust as tightly as practical for best performance.
16. Clear the work area of objects which might be picked up and snagged or entangled in the machine.
17. Keep hands, feet, hair, jewelry, and clothing away from all moving and/or rotating parts.

Component Pairs

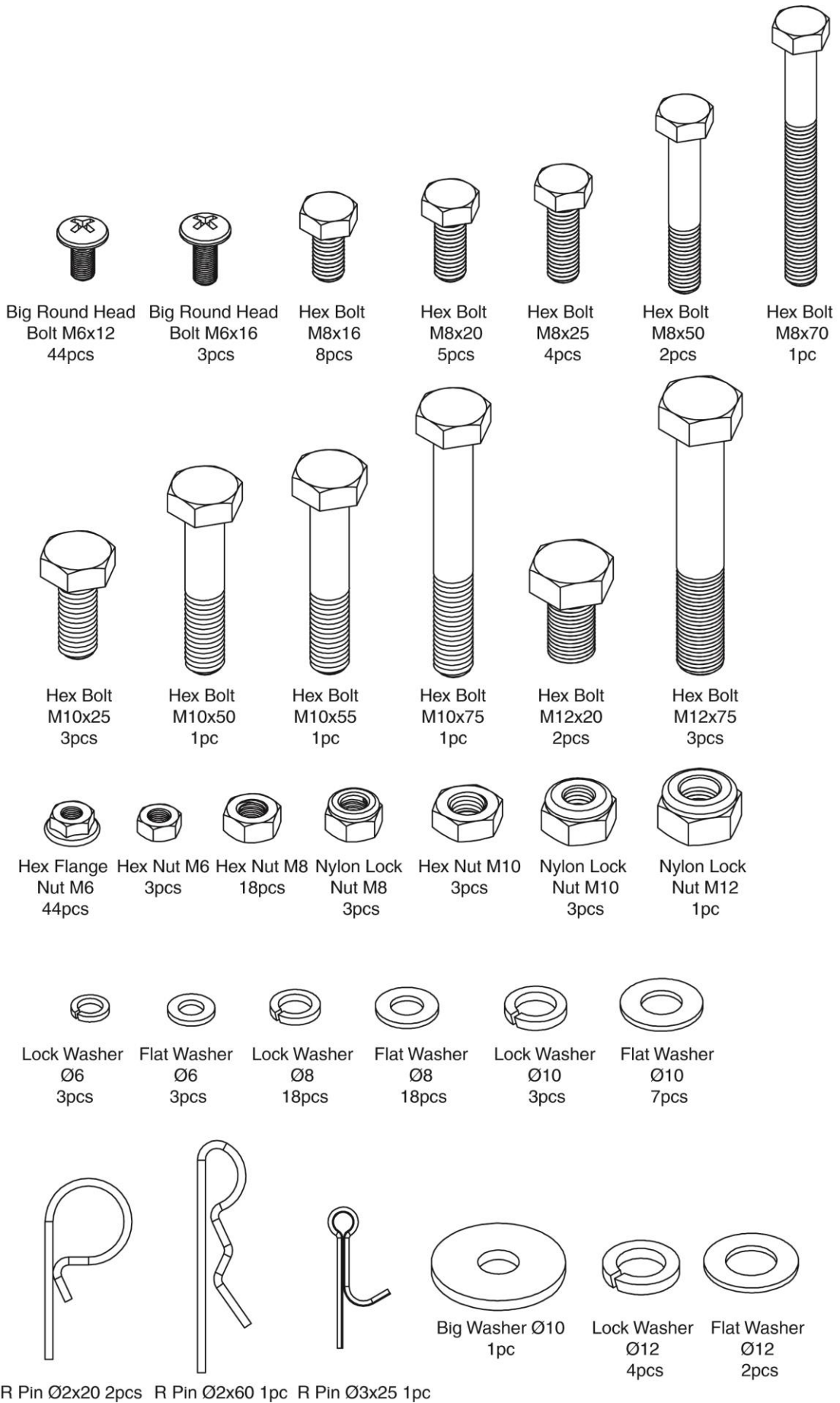

ASSEMBLY INSTRUCTION

STEP 1.

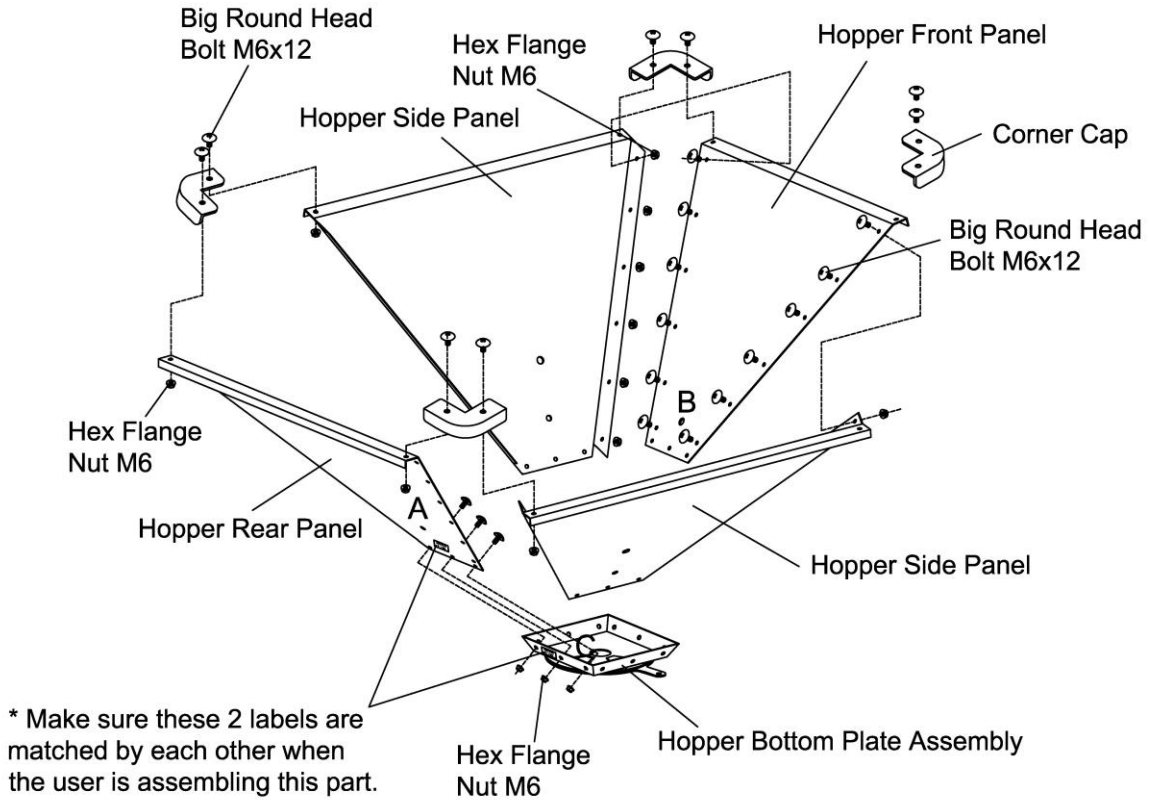

- NOTE: 1). Assemble the 4 panel by bolts and nuts according to drawing.
2). Assemble the Hopper Bottom Plate by bolts and nuts according to drawing.
3). Assemble the 4 Corner Cap by bolts and nuts, then tighten all the bolts and nuts.
4). Please adjust the direction of hopper for easy assembly.
5). After finishing the hopper assembly, please have the side with label downwards for next assembly.

STEP 2.

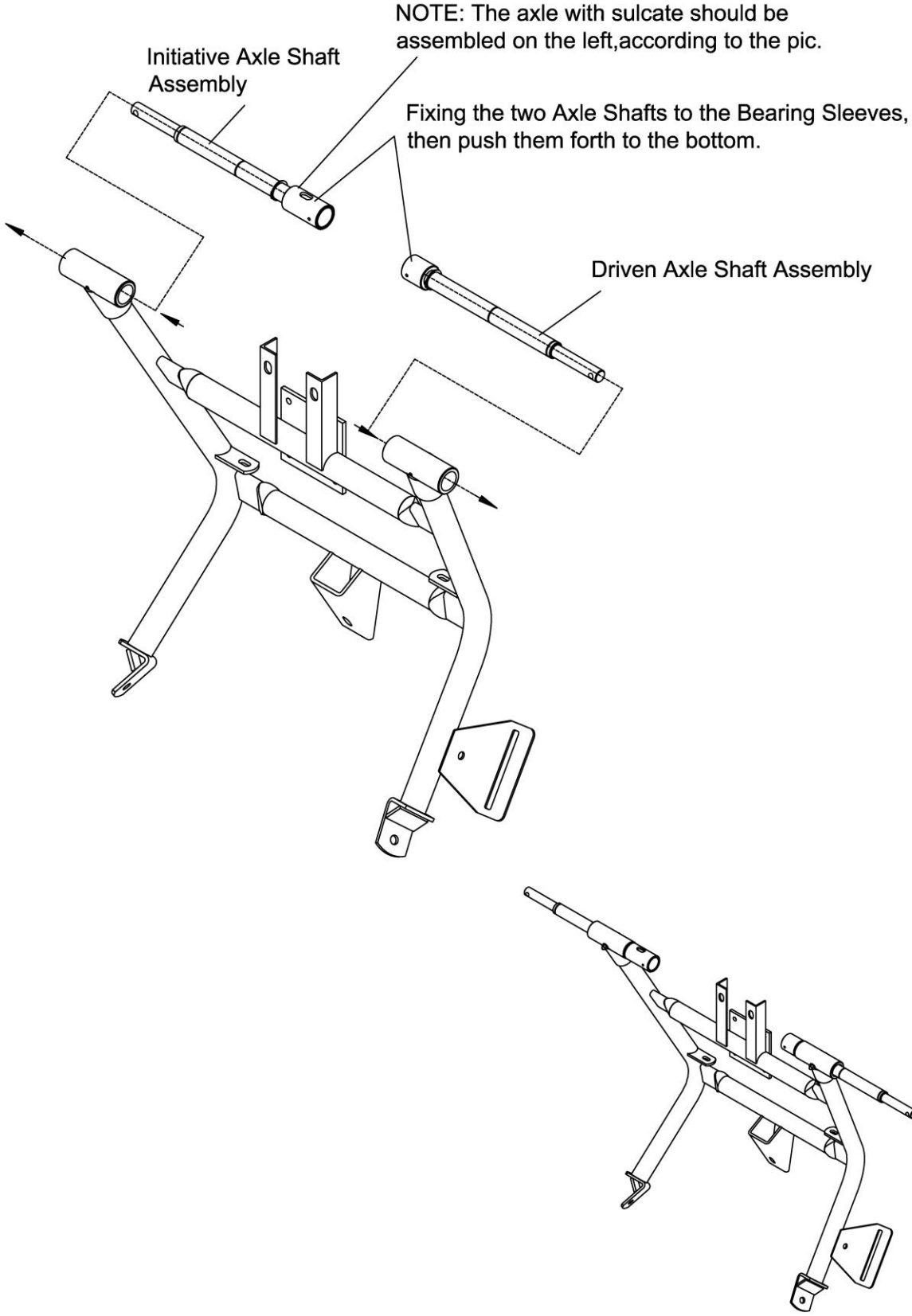

STEP 3.

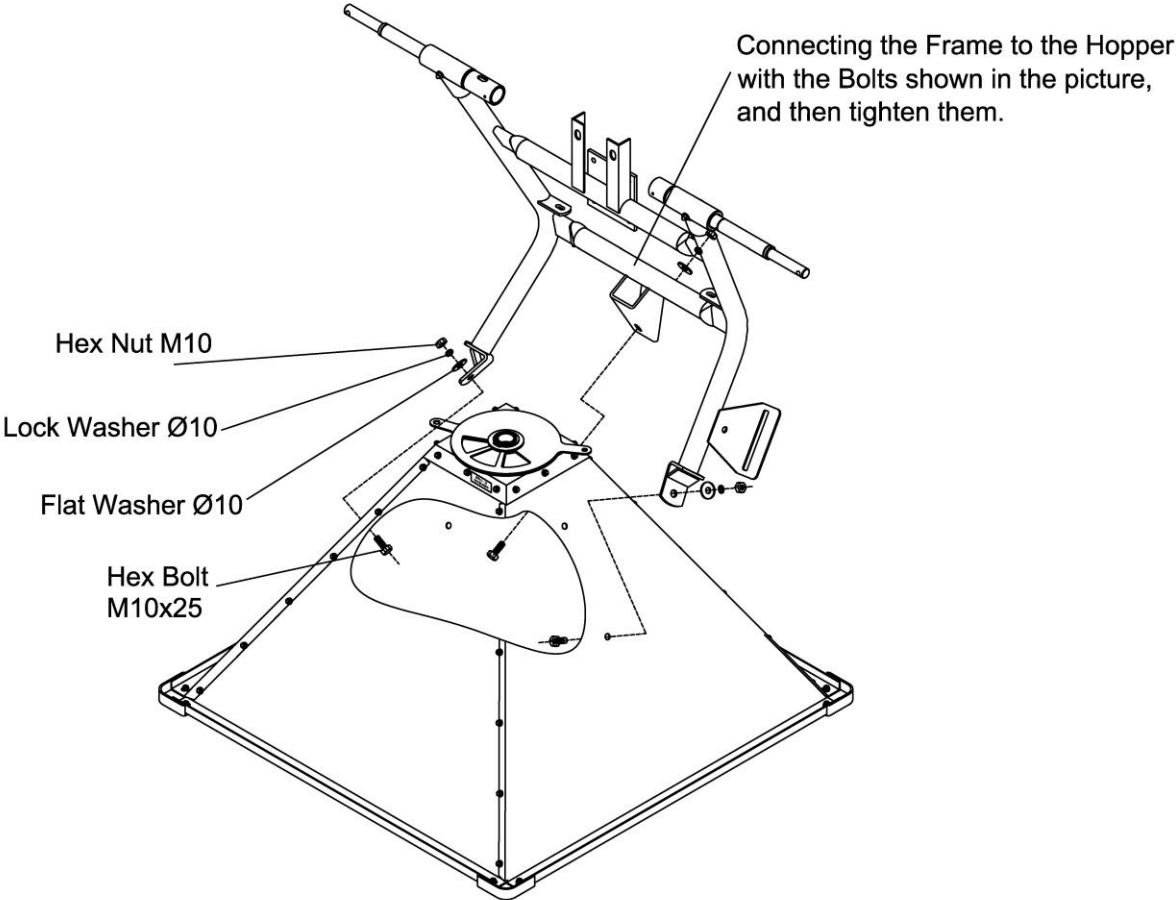

When assembly, please have the hopper side lay, the hopper panel with label should be put in downwards.

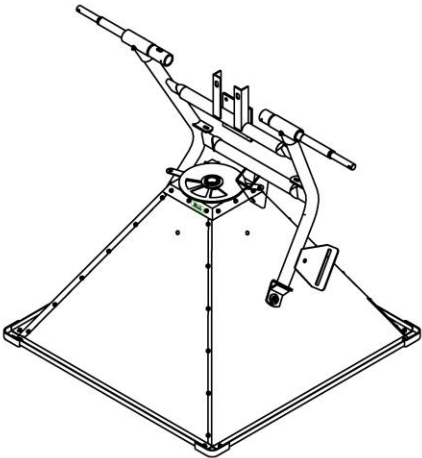

STEP 4.

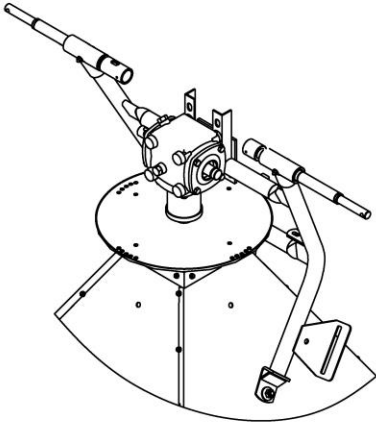
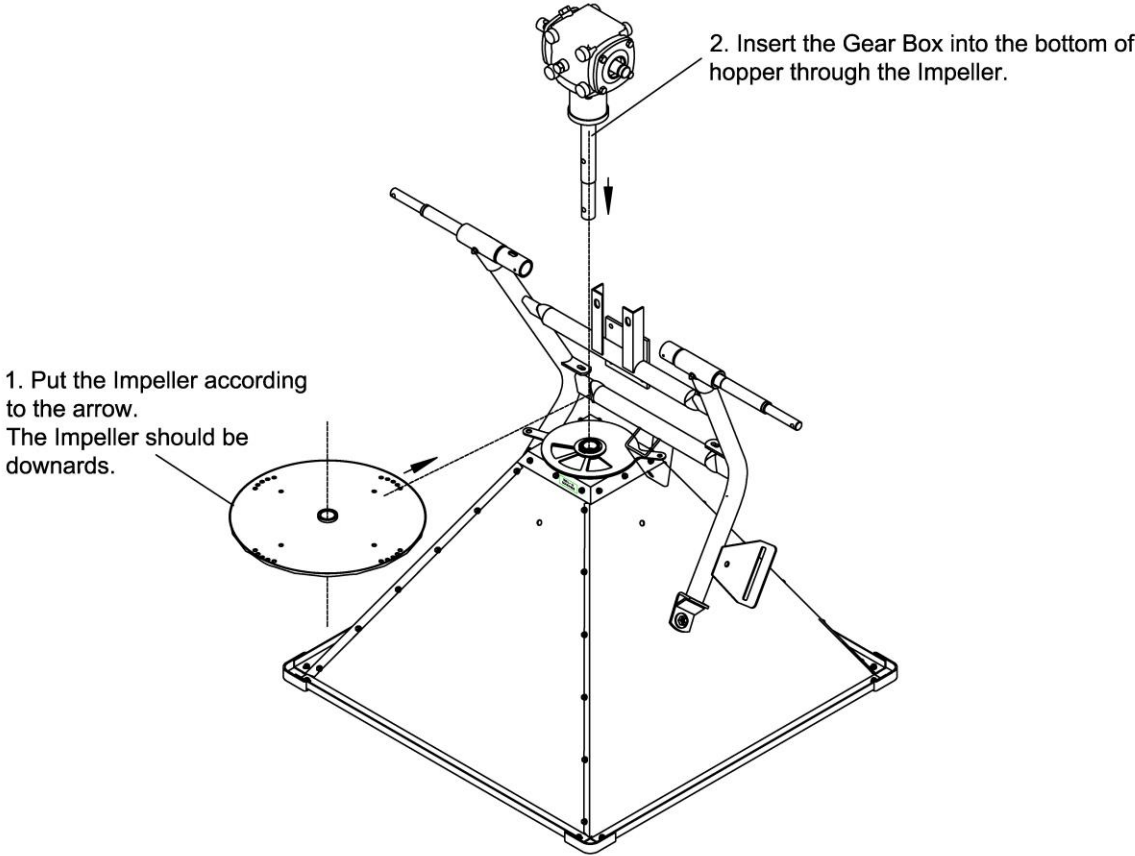

STEP 5.

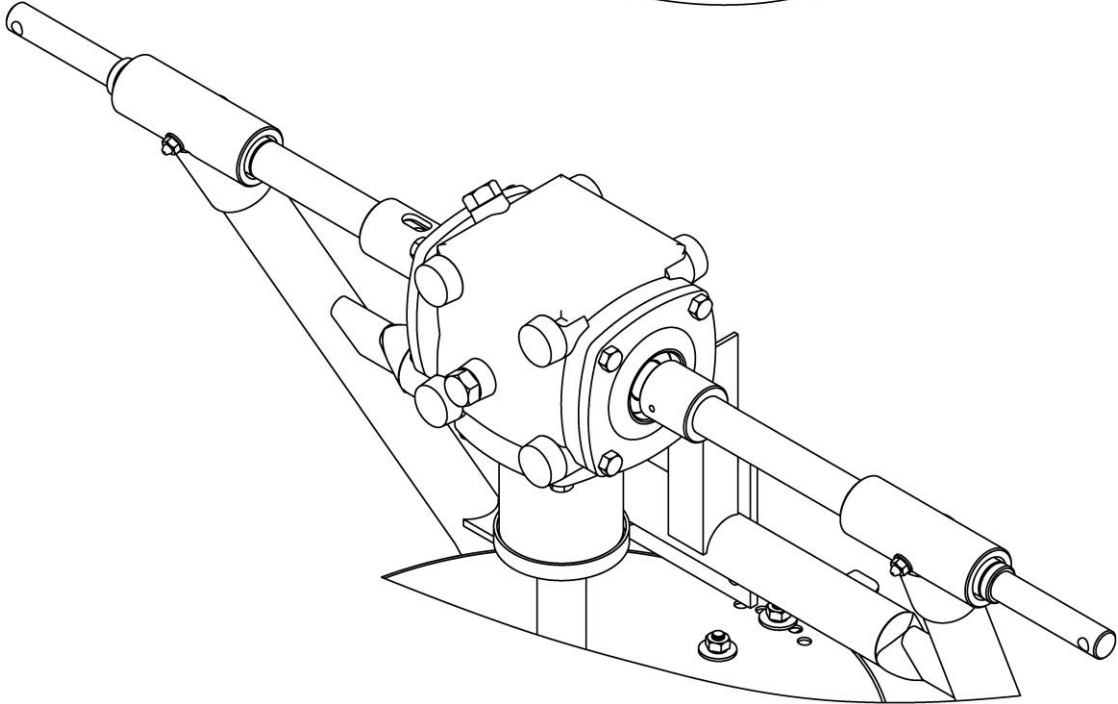
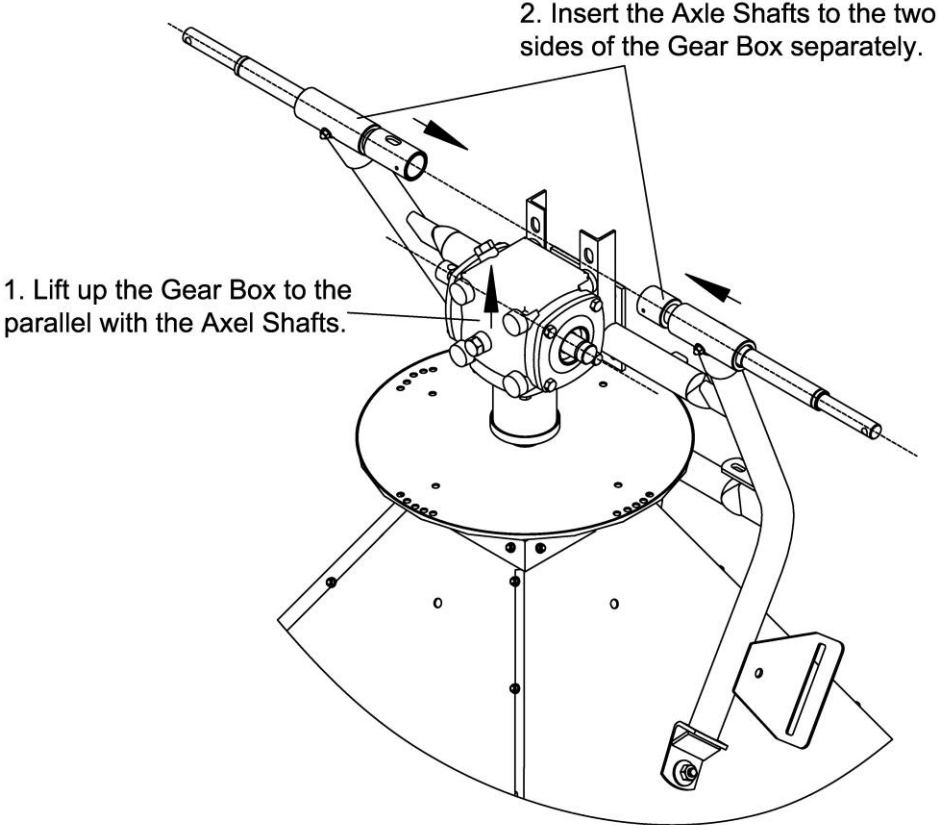

STEP 6.

Let the Gear Box hole and Axle Shaft Hole in the same level, then insert the Safety Pin.
(This pin could be took off when it not work so that could lessen the abrasion)

3. Insert 2 Snap Ring Ø25 to head of axle, put in its position.

2. Insert 2 Snap Ring Ø25 to head of axle, put in its position.

1. Connecting the Gear Box to the Frame with the bolts shown in this picture, wait to tighten after other parts be assembly fully.

Flat Washer Ø12

Lock Washer 12

Hex Bolt M12x20

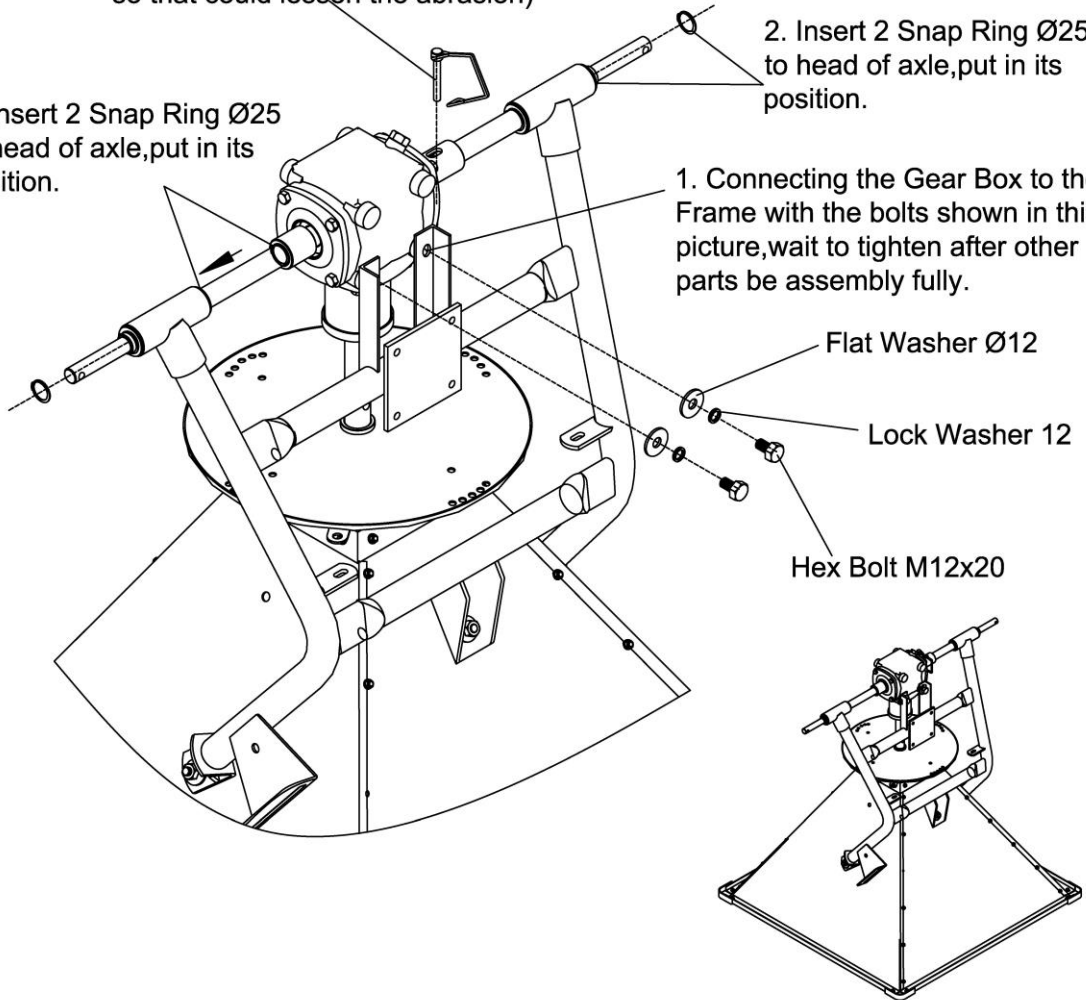

STEP 7.

Assembly two tires to the Shafts, the small hole of tires should aim at the hole of shafts then insert the bolts, tighten

Lock Nut M8
Flat Washer Ø8
Hex Bolt M8x50

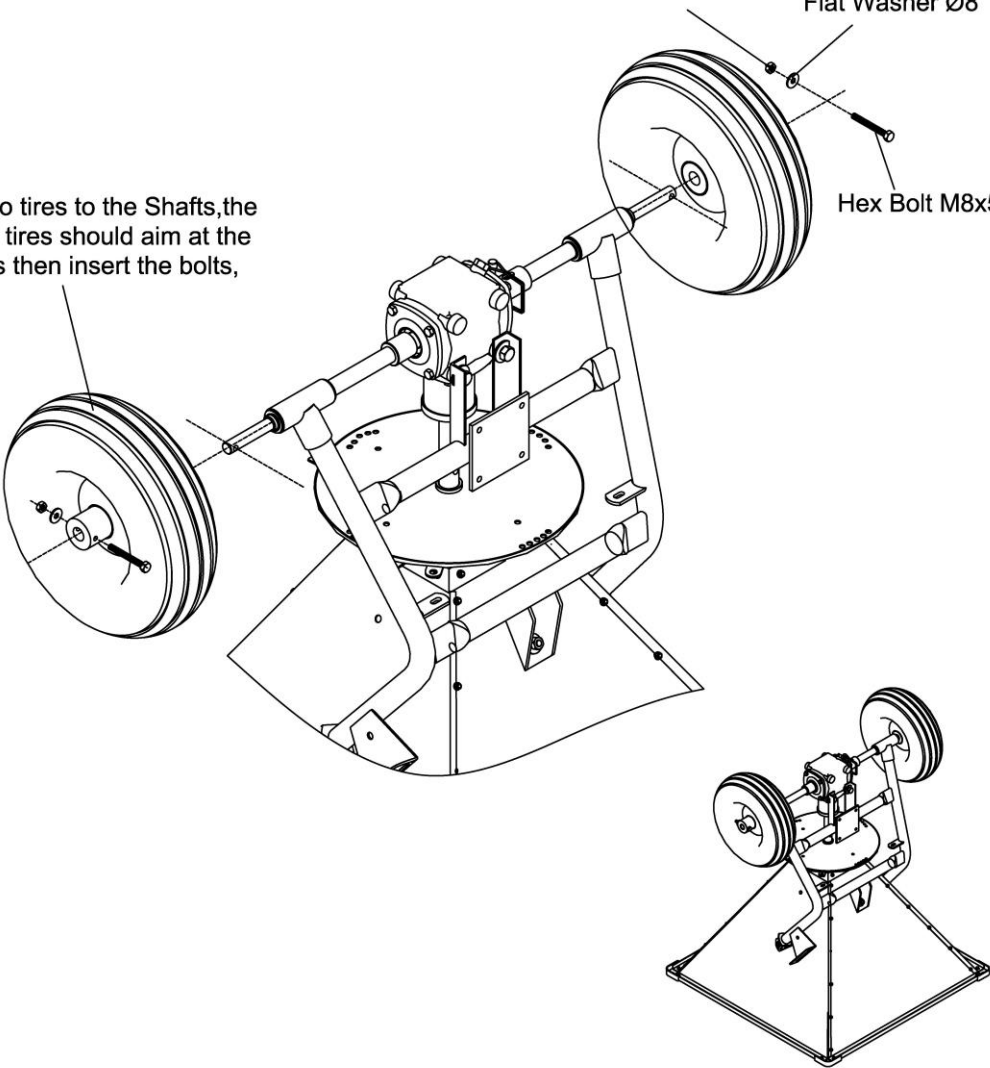

STEP 8.

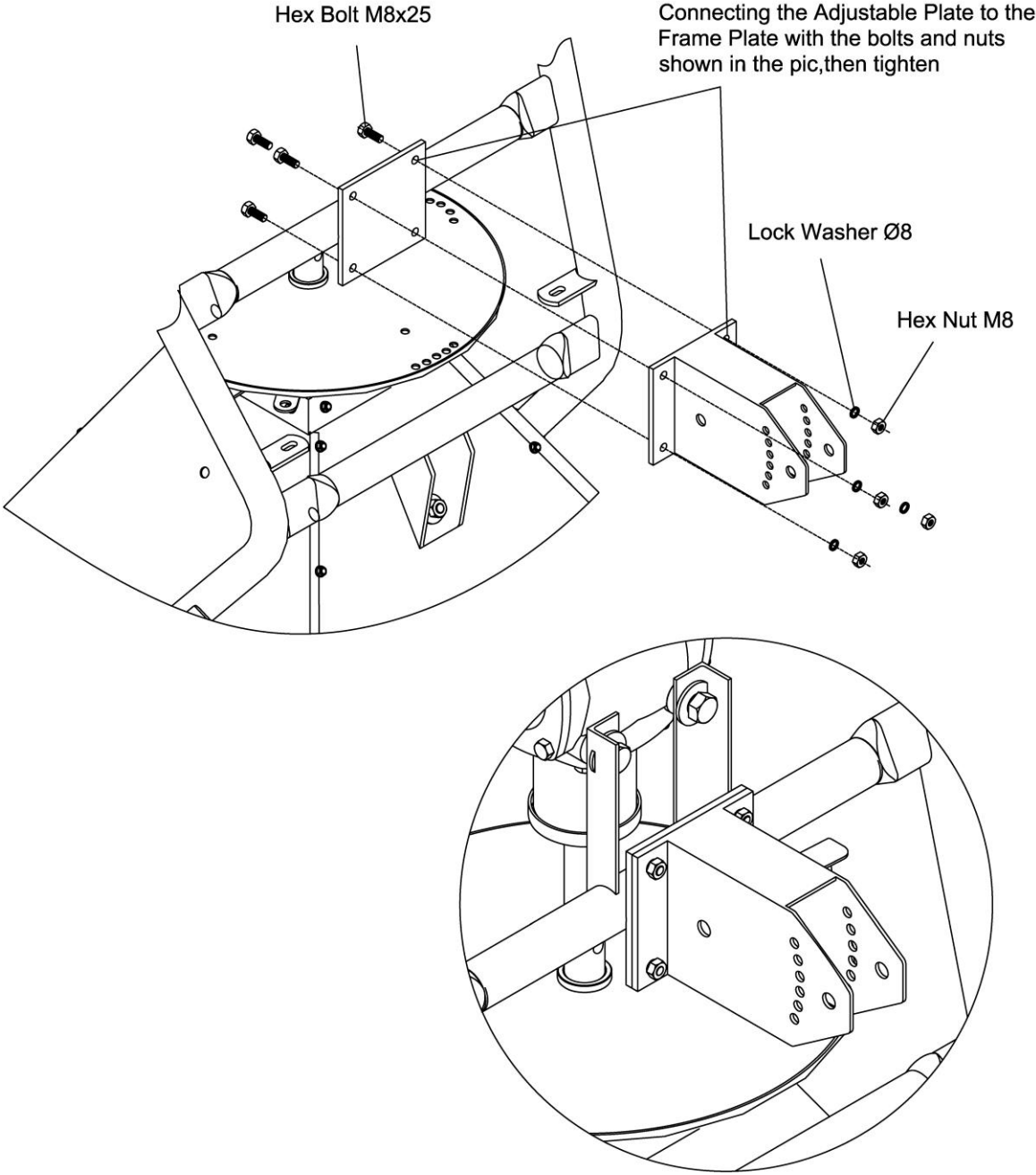

STEP 9

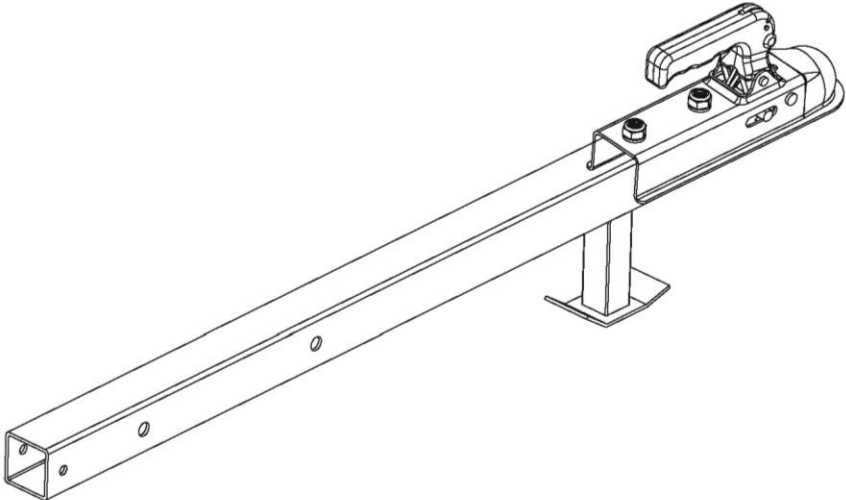
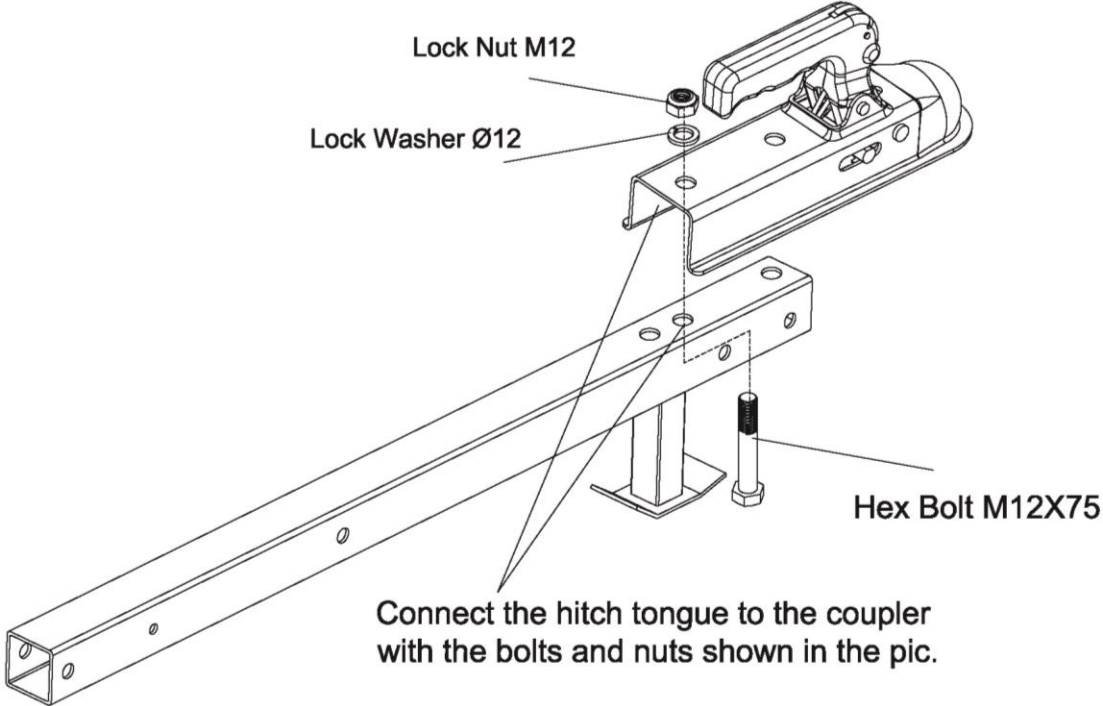

STEP 10.

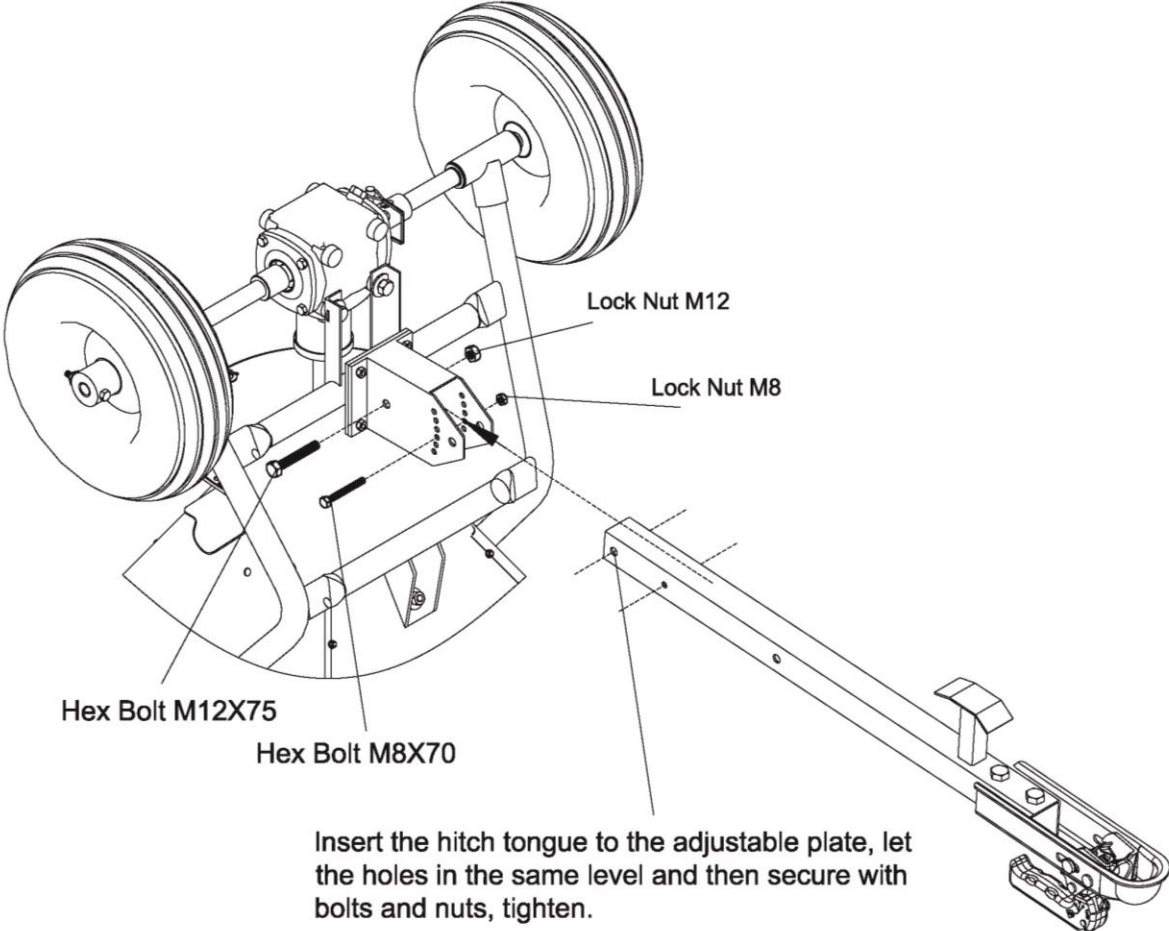

Now, turn over the spreader and make sure the hopper is upward.

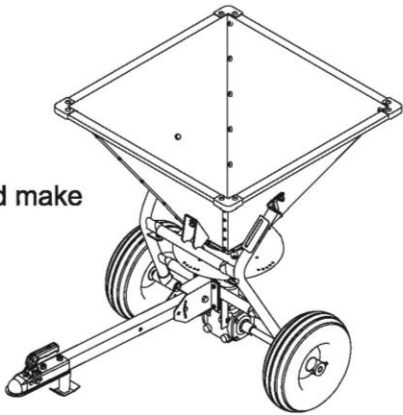

STEP 11.

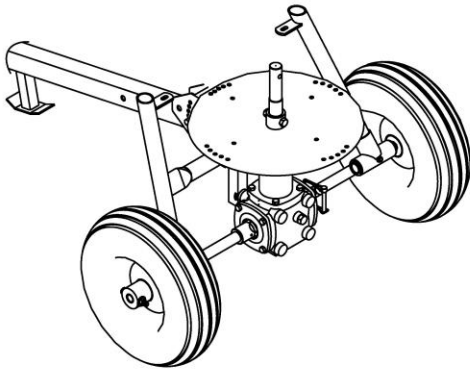
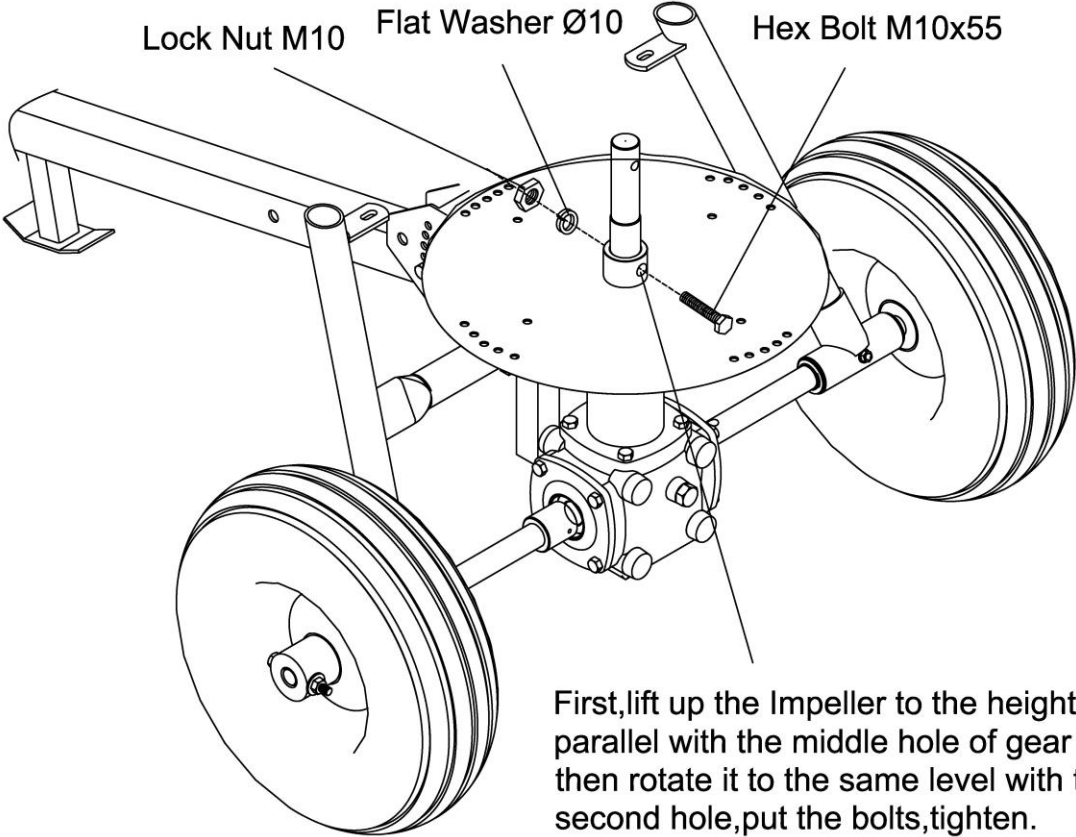

STEP 12.

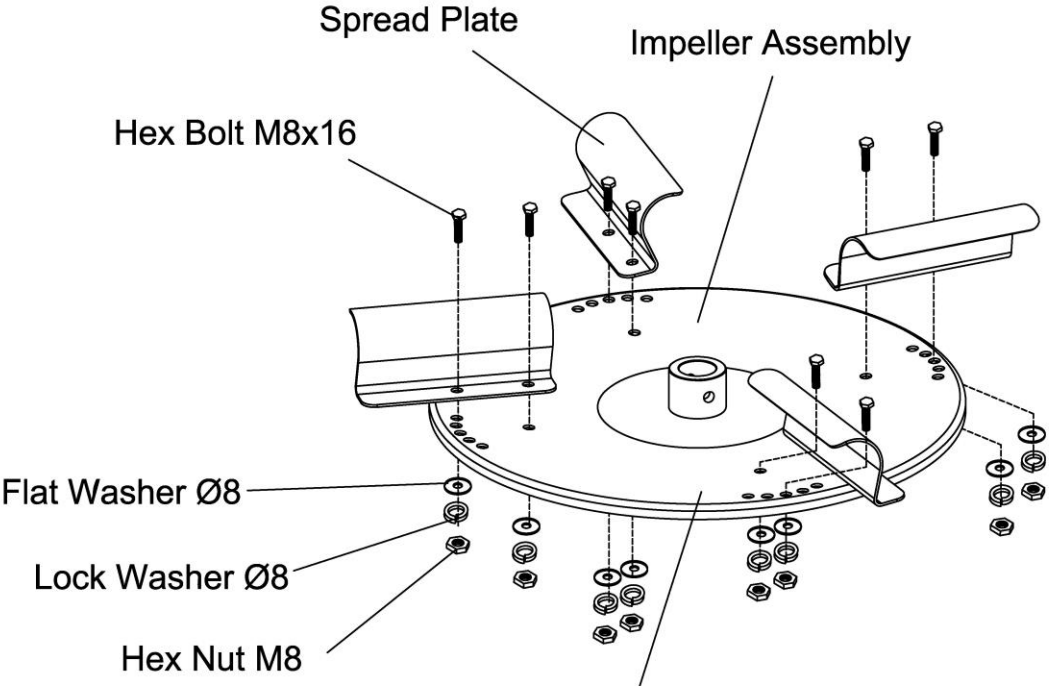

Assemble the Spread Plate to the Impeller accordingly, secure with bolts, washers & nuts.

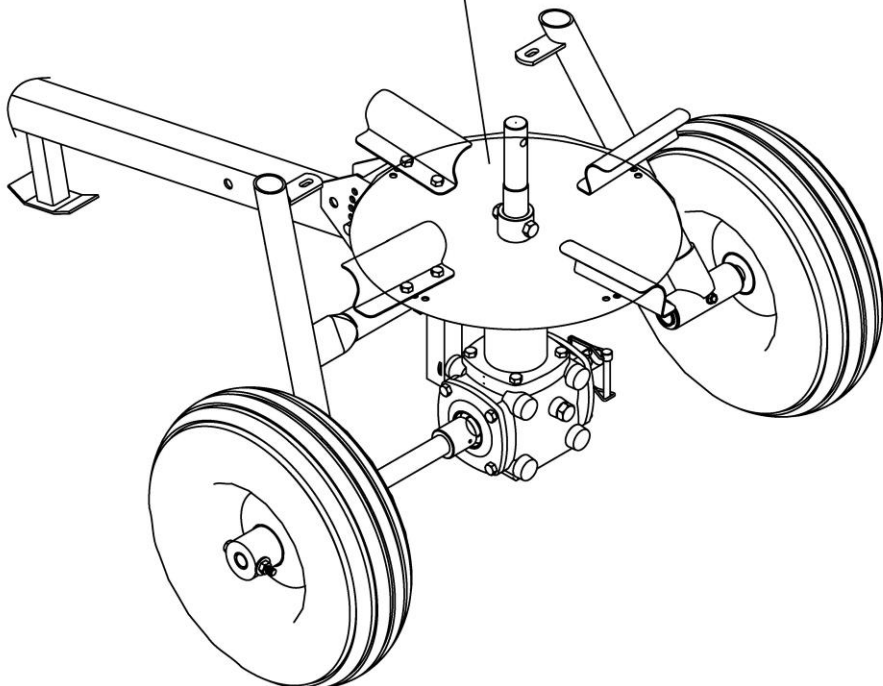

STEP 13.

Let the holes of Fixed Plate and Frame in the same level, insert the bolts, washers and nuts, tighten.

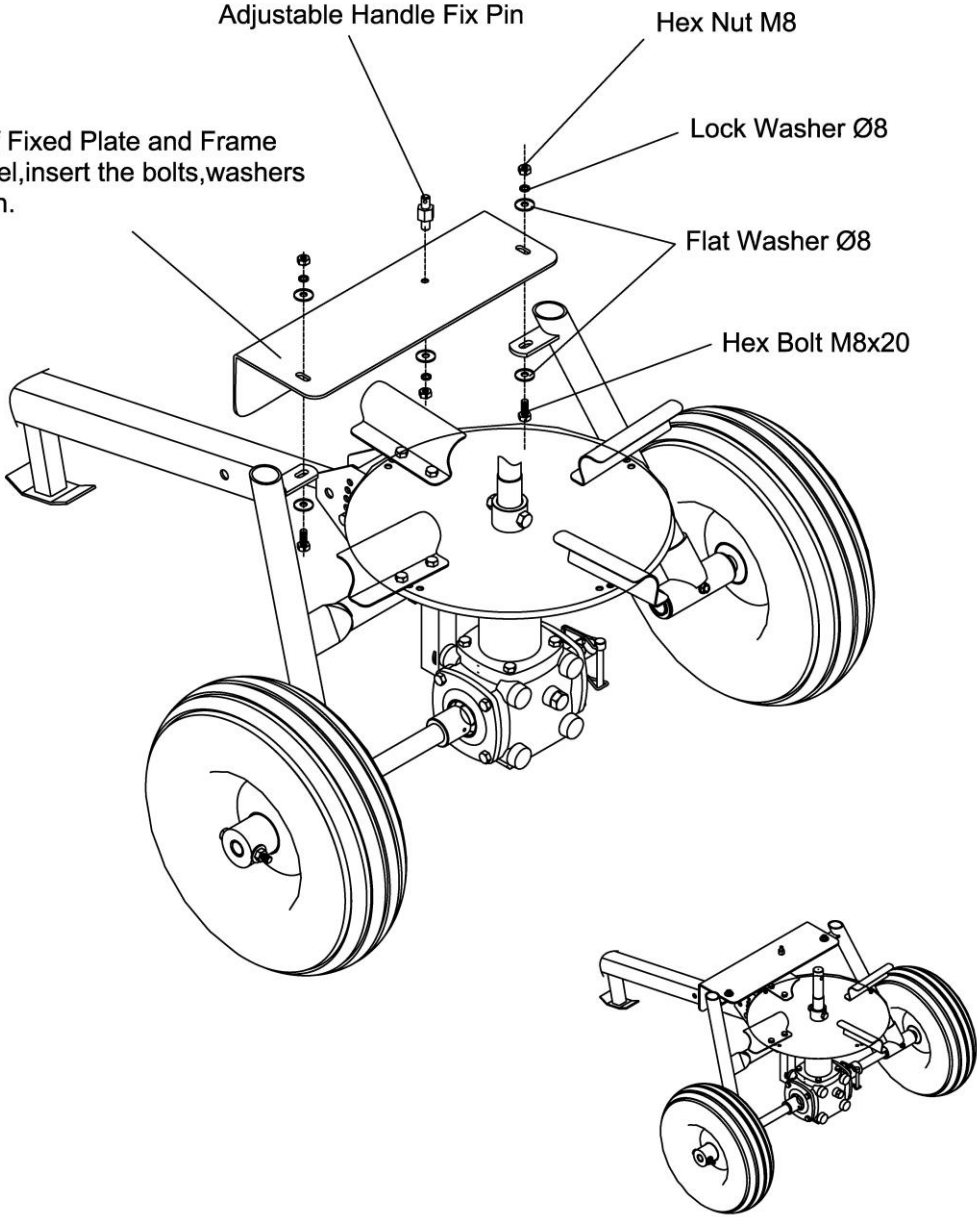

STEP 14

1: Insert the Adjustable Handle into the slot according to the indication in the pic. then put on the bolts, nuts and washers, tighten them to fix the handle and couldn't be moved.

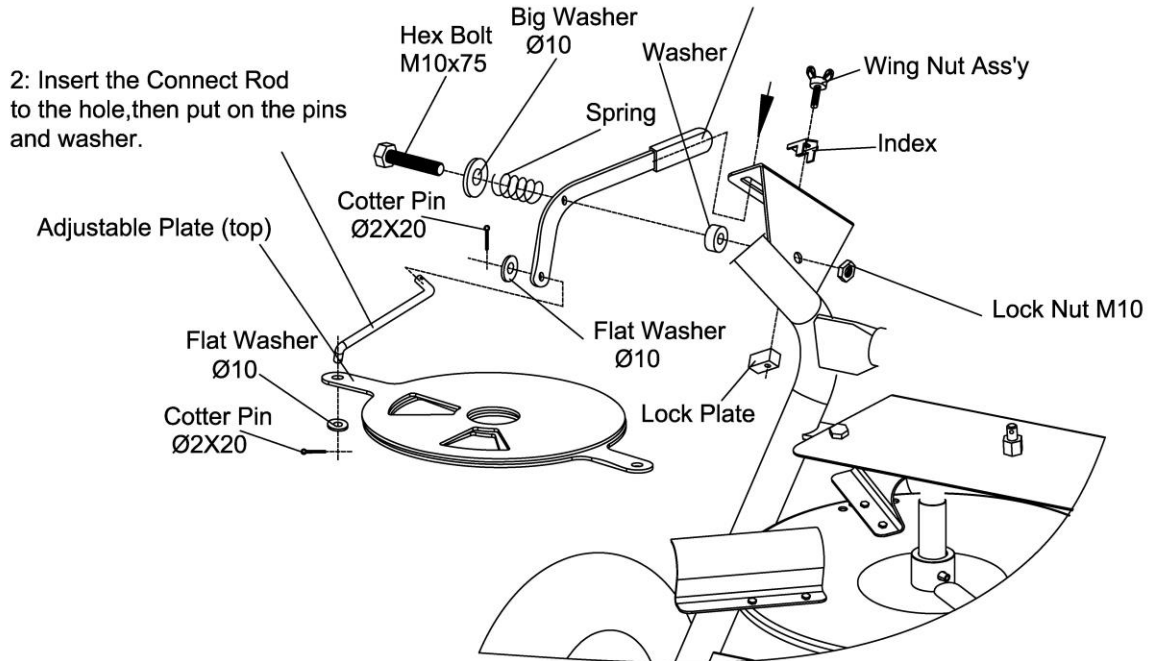

Moving this handle, it could adjust the stuff volume that spreader out on the bottom.

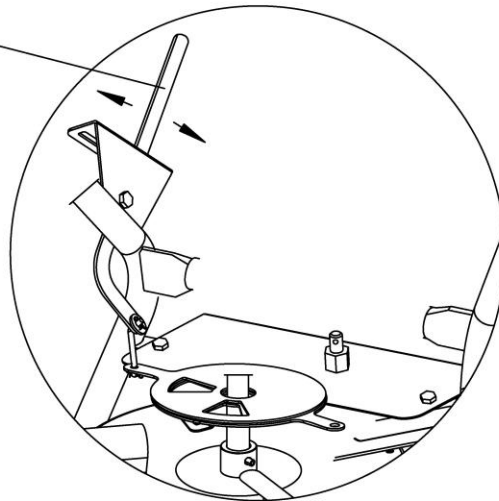

STEP 15

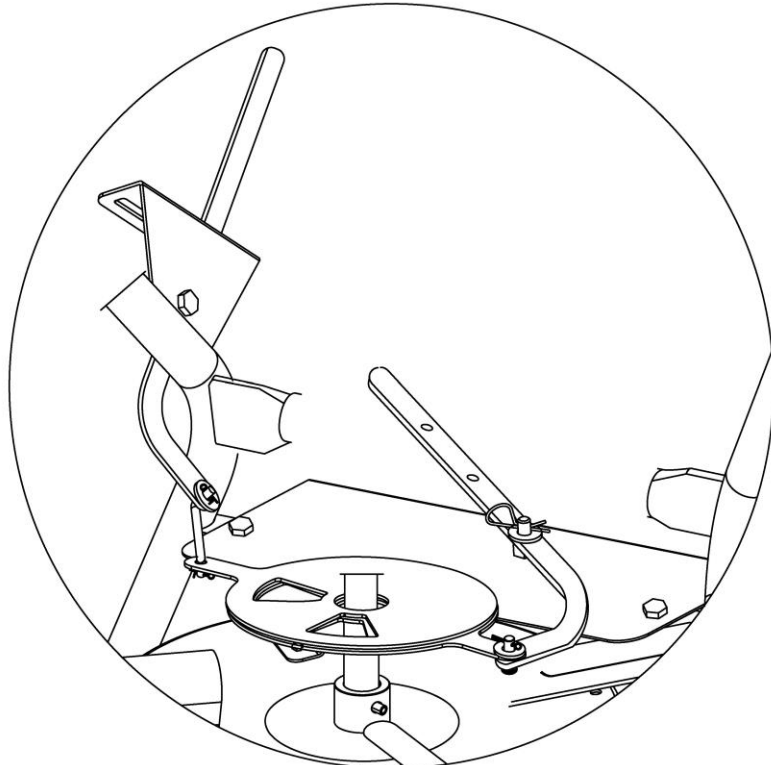
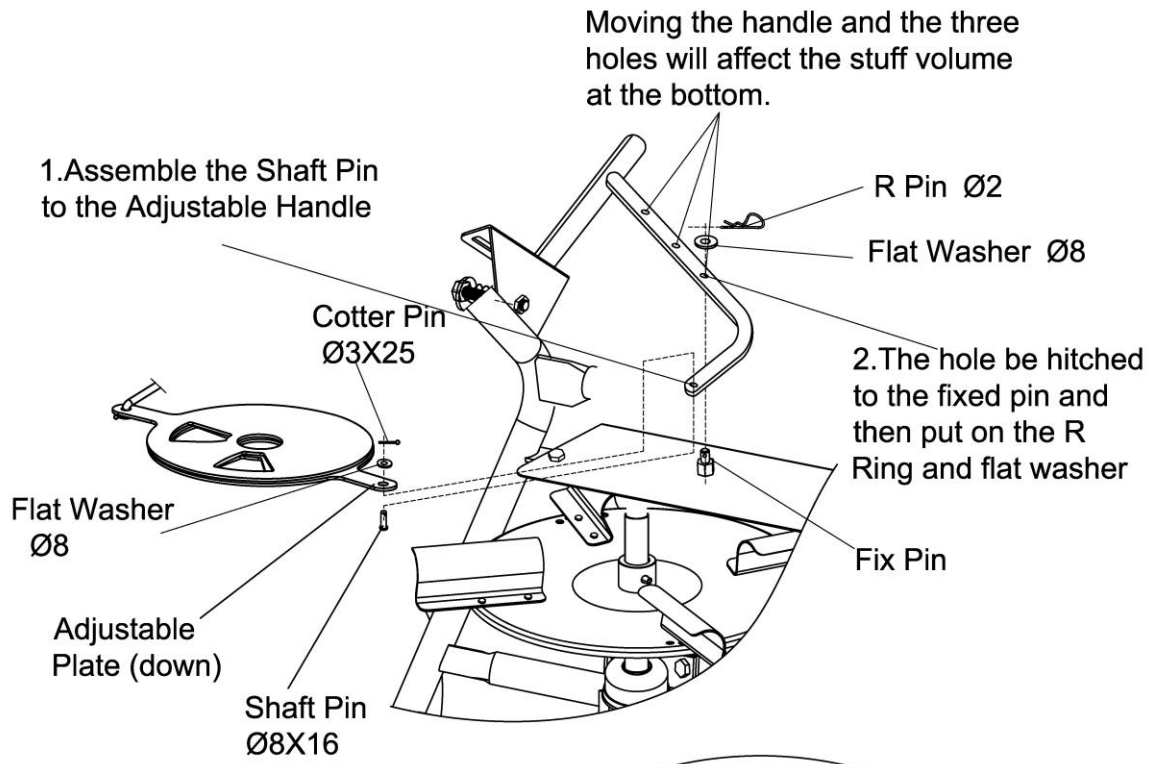

STEP 16

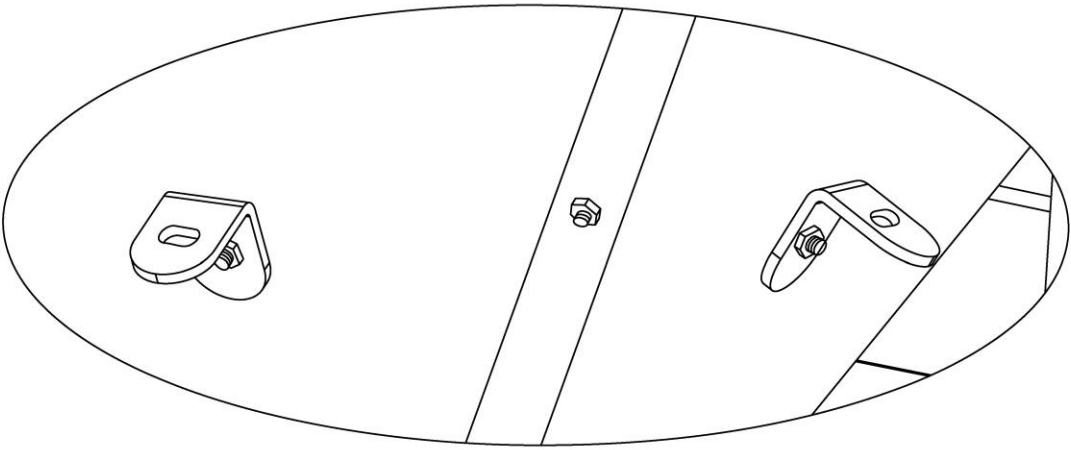
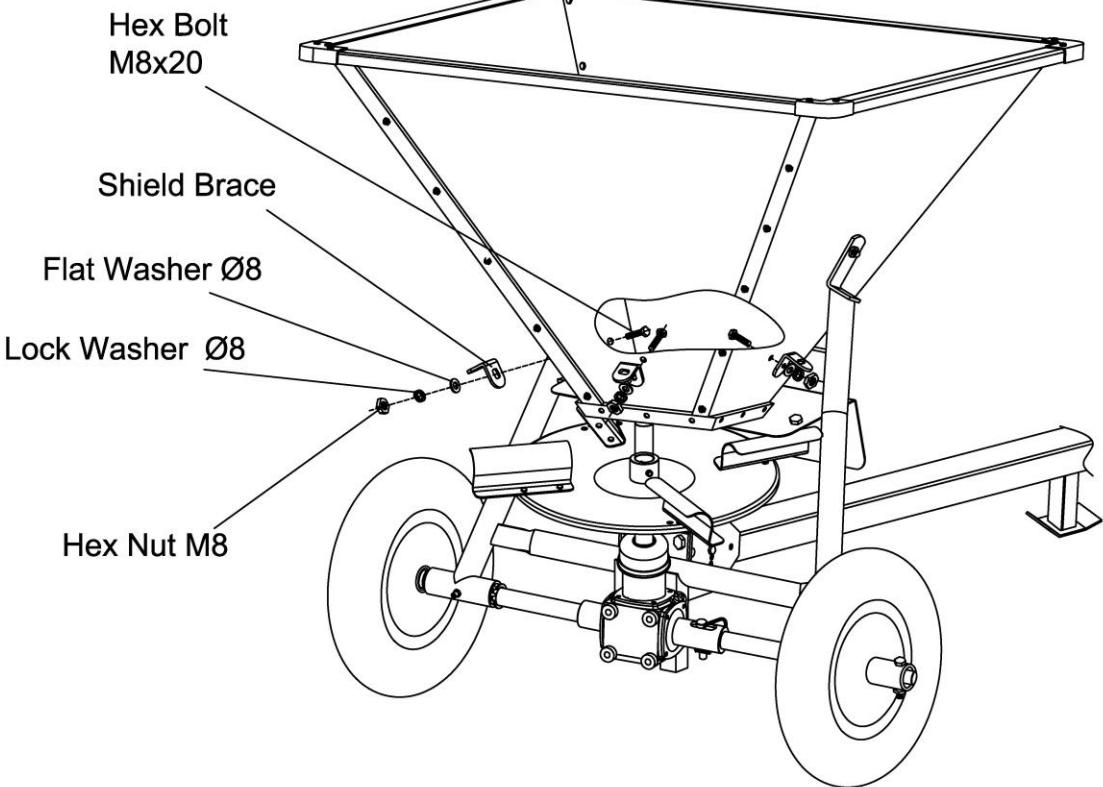

STEP 17

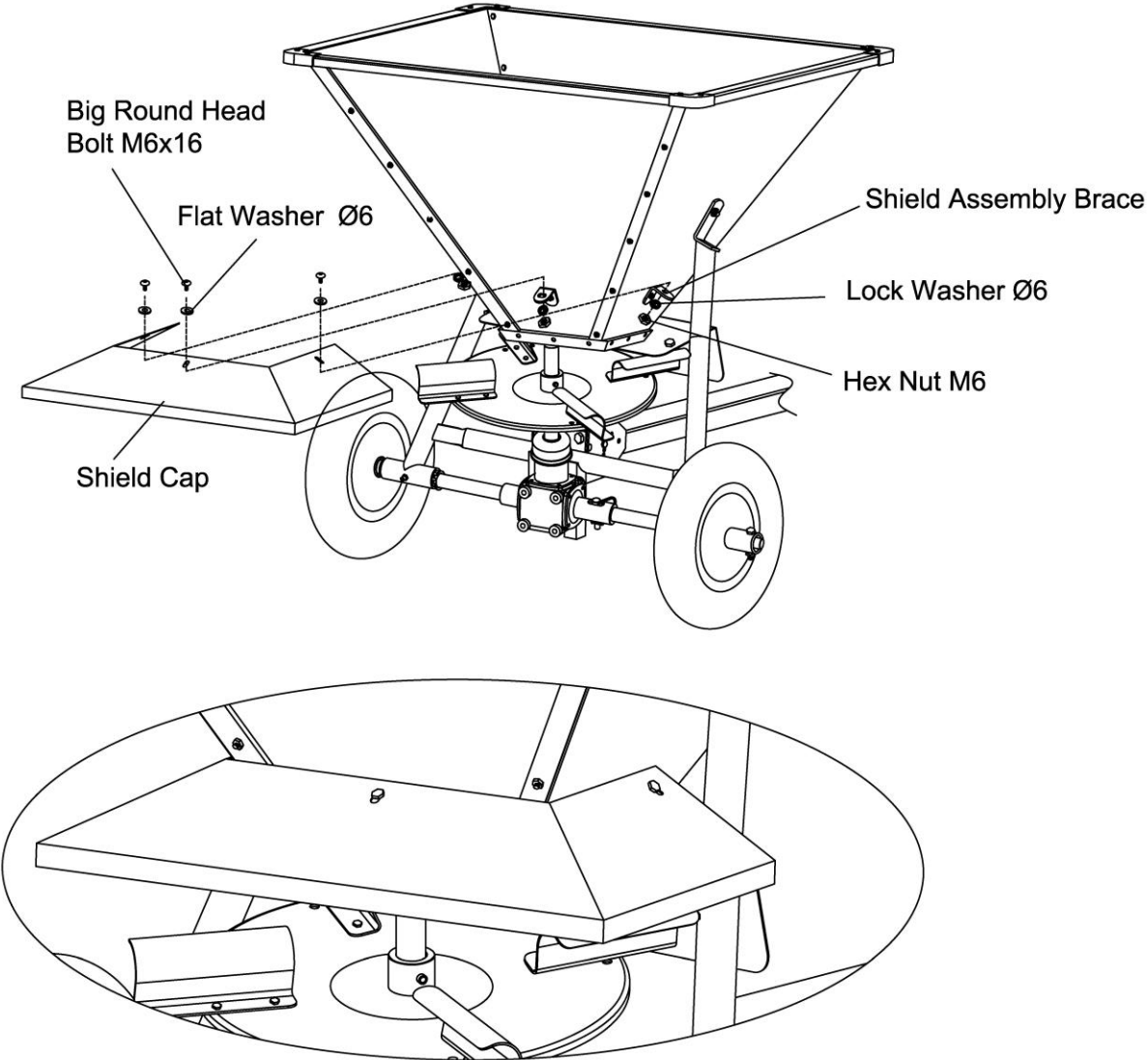

Tighten all bolts as well as the bolts that haven't tightened in the above step.

STEP 18

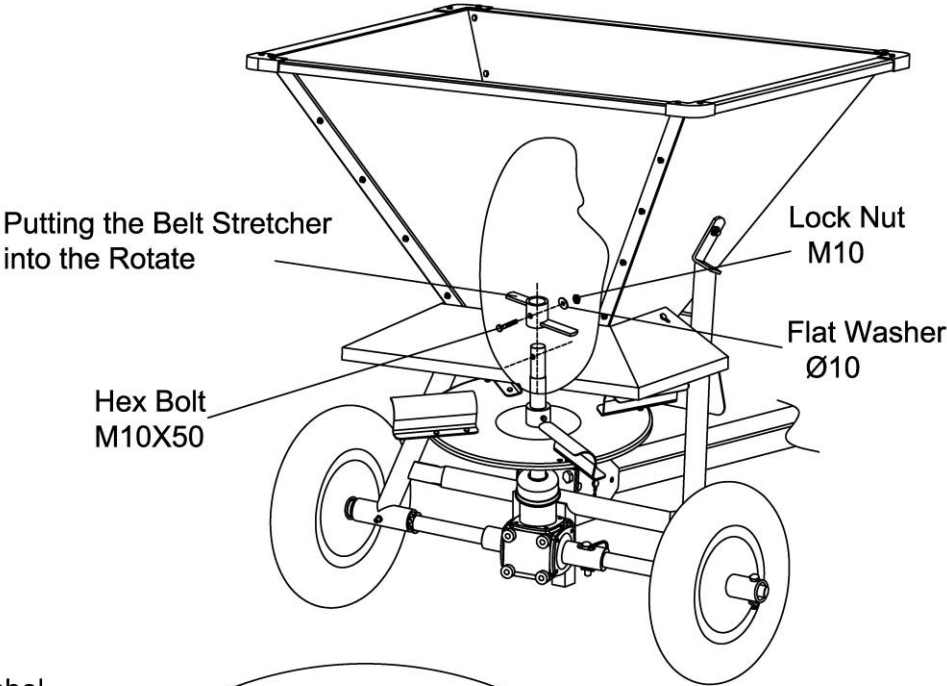

NOTE: This label should be in upwards

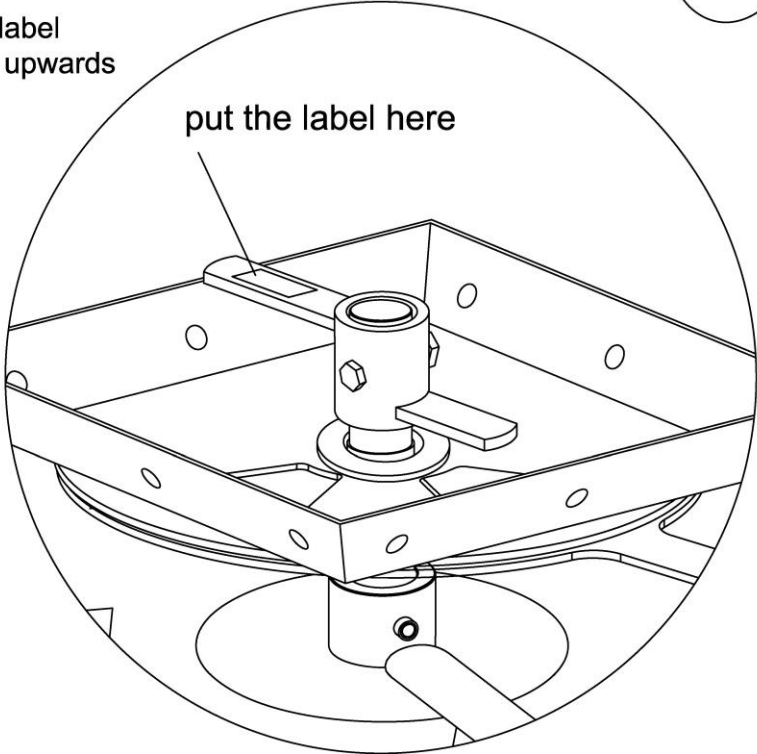

OPERATING INSTRUCTIONS

Please Read Instruction Carefully!

1. Right-hand or left-hand reference is determined by standing at the rear of the seeder/spreader and facing in the direction of travel of the tractor.
 2. Check the register of the control lever indicator with the seed gate (material gate). With the seed gate closed, the control lever should be in its fully raised position. Control lever settings listed on the spreader charts are to the adjustable pointer/stop below the control lever.
 3. DO NOT FILL HOPPER (especially with fertilizer) and transport over long distance, as it may result in packing, causing poor or erratic discharge.
 4. FOR BEST RESULTS use palletized fertilizer, as it has little tendency to lump and causes little or no dust.
 5. Be sure to sift or break up lumps found in some types of granular fertilizer before filling hopper.
 6. Do not use on windy days, especially when spreading fine grass seed.
 7. Be extremely careful if you are spreading herbicides, as there is the possibility of wind of drift or overthrow into areas where serious crop/shrub damage could occur. Always follow instructions on chemical package.
 8. Adjust the tension on the control handle so it moves with some resistance, but will remain where you set it. Adjust the control handle stop so that at the end of the field you can shut the seed gate and, after your turn, re-open to your exact setting.
 9. If, by chance, the agitator does become jammed, open the feed gate all the way. By sticking a small rod through the feed gate, the material jamming the agitator can be loosened and removed.
- After the jam is cleared, reset the feed gate and proceed.

SPREADING INSTRUCTIONS

1. The opening in the hopper bottom is regulated by the control handle. The size of the opening is determined by the calibrated scale. Place the control lever at the desired setting.
2. The spread chart in this manual is an approximate guide based on various forward speeds. For accurate spreading, calibrate your tractor to operate at the desired speed..
3. Check rate chart for suggested setting for material type to be spread.
4. You are now ready to make a trial run to assure accurate results. Close the feed gates and put in a pre-determined amount of the material to be spread. Spread this and check the results. Make final adjustments to obtain desired results.

MAINTENANCE

1. The hopper should be washed after use, especially after use with corrosive material such as fertilizer, salt or ice melting compounds. When dry, oil thoroughly.
2. The gearbox is filled with lubricant and sealed at the factory. If operated and stored properly, the gearbox will provide a long, trouble-free service life. If disassembly of the gearbox should ever be required, it is important that the box be re-filled with a good quality grease and that the box halves are resealed with a silicone adhesive.
3. Always store seeder/spreader in a clean, dry place.
4. Before using, check to make sure all nuts and bolts are tight.
5. Paint any bare metal or rusty spots for longer life.

SPREADING CHART FOR SEED

MATERIAL	SPREAD WIDTH IN FEET	TRACTOR SPEED (MPH)	POUNDS PER ACER (APPROXIMATE) AT CONTROL LEVER SETTING INDICATED								
			0.5	1	2	3	4	5	6	7	8
Alfalfa & Clover	24'	4	18	62	153						
		5	14	51	124						
		6	12	42	103						
		7.5	10	34	88						
Barley	26'	4				94	117	139	196		
		5				76	94	112	157		
		6				63	78	92	130		
		7.5				50	62	74	105		
Bluegrass & Bermude Grass	17'	4			27	94					
		5			21.5	58.5					
		6			17.5	54					
		7.5			14	31					
Brome Grass	9.5'	4	9	15.5	25						
		5	8	12	19.5						
		6	6.5	10	15						
		7.5	5	8	13						
Fescue & Ryegrass	17'	4		14	44	104					
		5		12	35	77					
		6		10	29	64					
		7.5		8	23	51					
Lespedeza	30'	4	6.5	14	29						
		5	4.5	12	23						
		6	4	10	19.5						
		7.5	3	8	15.5						

Oats	26'	4 5 6 7.5				59 47 39 31	92 74 62 49	170 137 113 91			
Orchard Grass	11'	4 5 6 7.5			18 14 12 9	27 22 18 14					
Rice	31'	4 5 6 7.5				113 91 75 61	182 146 121 98	329 264 220 176			
Rye	31'	4 5 6 7.5				112 90 74 60	176 142 117 94	242 194 161 129	295 237 196 157		
Sudan Grass	31'	4 5 6 7.5			48 39 33 26	75 61 51 40	120 96 79 64				
Soybeans	38'	4 5 6 7.5					105 85 71 56	165 133 111 88	195 156 130 104	221 177 147 117	
Timothy	15'	4 5 6 7.5	18 14 12 10	62 51 42 34	153 124 103 82						
Wheat	31'	4 5 6 7.5				91 73 60 48	144 116 96 77	196 157 130 104	257 207 172 138		

DRAWING

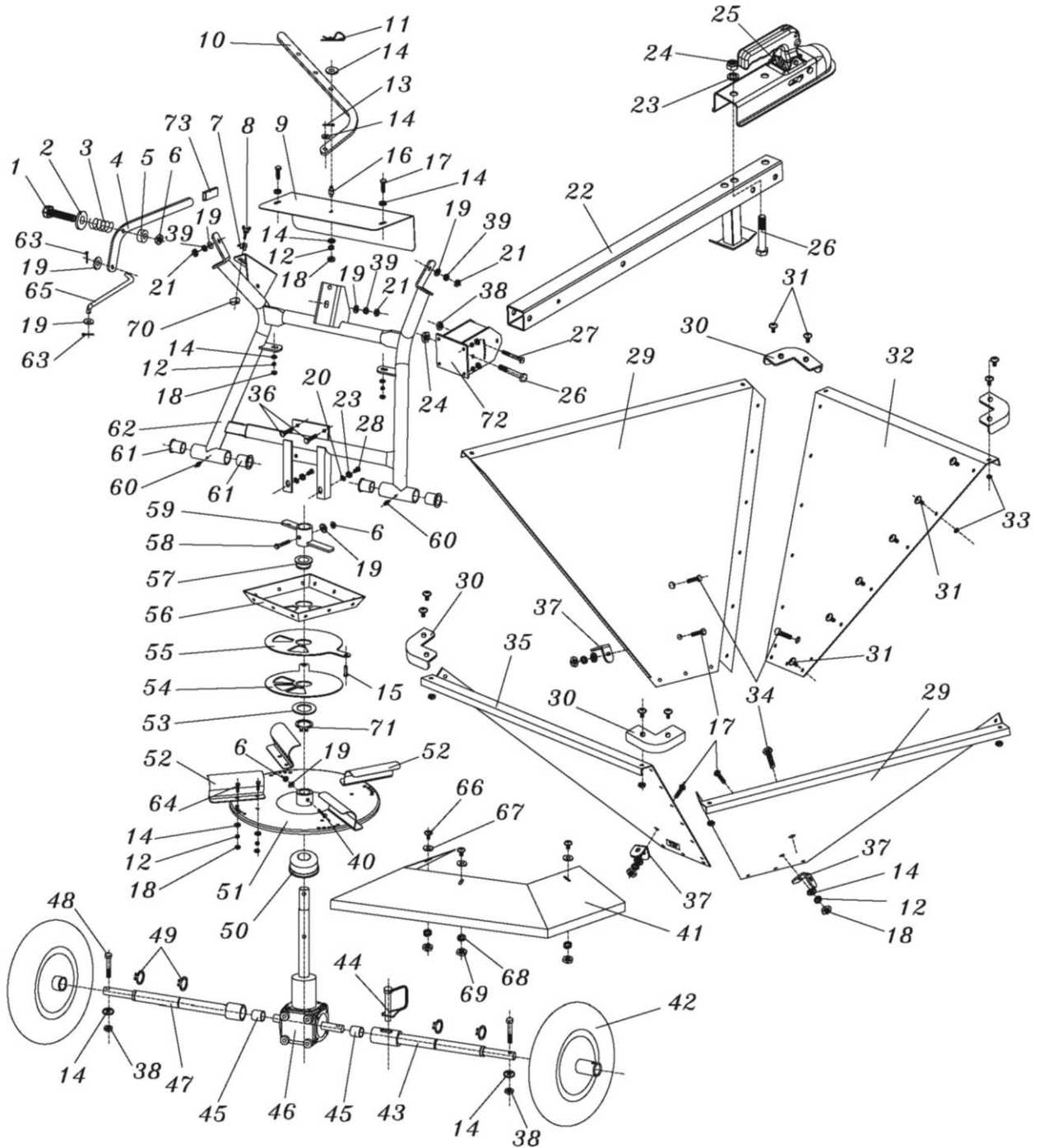

PARTS LIST

Ref#	Drawing No.	Description	Qty
1	9101-10075-DX	Hex Bolt M10x75	1
2	9302-10000-DX	Big Flat Washer Ø10	1
3	N560-00014-DX	Spring	1
4	N560-00009	Adjustable Handle (top)	1
5	N560-00017	Washer	1
6	9206-10000-DX	Hex Lock Nut M10	3
7	N560-00011-DX	Index	1
8	N560-90000-DX	Wing Nut Ass'y	1
9	N560-00008	Fixed Plate	1
10	N560-00010	Adjustable Handle (low)	1
11	N570-00017-DG	R Pin Ø2	1
12	9306-08000-DX	Lock Washer Ø8	18
13	9404-03025-DX	Cotter Pin Ø3x25	1
14	9301-08000-DX	Flat Washer Ø8	20
15	9403-08016-DX	Shaft Pin	1
16	N560-00006-DX	Handle Fix Pin	1
17	9101-08020-DX	Hex Bolt M8x20	5
18	9201-08000-DX	Hex Nut M8	18
19	9301-10000-DX	Flat Washer Ø10	7
20	9301-12000-DX	Flat Washer Ø12	2
21	9201-10000-DX	Hex Nut M10	3
22	N563-01000	Hitch Tongue	1
23	9306-12000-DX	Lock Washer Ø12	4
24	9206-12000-DX	Lock Nut M12	3
25	Z104	Coupler	1
26	9101-12075-DX	Hex Bolt M12x75	3
27	9101-08070-DX	Hex Bolt M8x70	1
28	9101-12020-DX	Hex Bolt M12x20	2
29	N560-10001	Hopper Side Panel	2
30	N180-00006	Corner Cap (Front)	4
31	919901-06012-DX	Big Round Head Bolt M6x12	44
32	N560-10003	Hopper Front Panel	1
33	9212-06000-DX	Hex Flange Nut M6	44
34	9101-10025-DX	Hex Bolt M10x25	3
35	N560-10002	Hopper Rear Panel	1
36	9101-08025-DX	Hex Bolt M8x25	4
37	N560-00013-DX	Shield Brace	3

Ref#	Drawing No.	Description	Qty
38	9206-08000-DX	Lock Nut M8	3
39	9306-10000-DX	Lock Washer Ø10	3
40	9101-10055-DX	Hex Bolt M10x55	1
41	N560-00007	Shield Cap	1
42	N560-80000	Wheel	2
43	N560-52000-DX	Initiative Axle Shaft Ass'y	1
44	T400-40000-DX	Safety Pin	1
45	N560-50018	Composite Bearing	2
46	N560-50000	Gear Box Ass'y	1
47	N560-53000-DX	Driven Axle Shaft Ass'y	1
48	9101-08050-DX	Hex Bolt M8x50	2
49	9304-25000-FH	Lock Retaining Ring Cap Ø25	4
50	N560-50008	Dust Cover	1
51	N560-70000	Impeller Ass'y	1
52	N560-00004	Spread Plate	4
53	N560-00005-DX	Flat Washer Ø40	1
54	N560-00002-DX	Adjustable Plate (down)	1
55	N560-00003-DX	Adjustable Plate (top)	1
56	N560-10004	Hopper Bottom Plate	1
57	N560-00001-DX	Axle Bush	1
58	9101-10050-DX	Hex Bolt M10x50	1
59	N560-40000-DX	Agitator	1
60	9701-06000	Oil Cup	2
61	N560-00015	Bearing	4
62	N560-20000	Frame Ass'y	1
63	9404-02020-DX	Cotter Pin Ø2x20	2
64	9101-08016-DX	Hex Bolt M8x16	8
65	N560-01000-DX	Connecting Shaft	1
66	919901-06016-DX	Big Round Head Bolt M6x16	3
67	9301-06000-DX	Flat Washer Ø6	3
68	9306-06000-DX	Lock Washer Ø6	3
69	9201-06000-DX	Hex Nut M6	3
70	N560-00012-DX	Lock Plate	1
71	9304-40000-FH	Lock Retaining Ring Cap Ø40	1
72	N560-60000	Adjustable Plate	1
73	N560-00019	Handle Grip	1